



SB12-150A FT V0 (12V150Ah)



Applications

- Uninterruptable Power Supply (UPS)
- Electric Power System (EPS)
- Emergency backup power supply
- Emergency light
- Railway signal
- Alarm and security system
- Communication power supply
- DC power supply

Certificates



Specifications

| | | | |
|---|---|-----------------------------------|--|
| Nominal Voltage | 12V | Nominal Oper. Temp. R. | 25±3°C |
| Nominal Capacity | 150Ah (C ₁₀ , 1.80V/cell) | Cycle Use | Initial Charging Current less than 45.0A. Voltage 14.7V +1% at 25°C. Temperature Coefficient -30mV/°C. |
| Approx. Weight | 46.9kg | Standby Use | No limit on Initial Charging Current. Voltage 13.65V +1% at 25°C Temp. Coefficient -20mV/°C |
| Terminal | M6 | Capacity affected by Temp. | 40°C 103% 25°C 100% 0°C 86% |
| Container Material | ABS UL94 V0 | Self Discharge | SB batteries may be stored for up to 6 months at 25°C and then a freshening charge is required. For higher temperatures the time interval will be shorter. |
| Rated Capacity (25°C) | 158.8Ah/7.94A, 20hr, 1.80V/cell 150.0Ah/15.0A, 10hr, 1.80V/cell 142.4Ah/17.8A, 8hr, 1.80V/cell 130.5Ah/26.1A, 5hr, 1.75V/cell 95.9Ah/95.9A, 1hr, 1.67V/cell | Life Expectancy | 10-12 years according to EUROBAT |
| Max. Discharge Current | 1200A (5s) | | |
| Internal Resistance / Impedance (1kHz) | Approx. 4.3mΩ | | |
| Operating Temp. Range | Discharge: -15~50°C Charge: 0~40°C Storage: -15~40°C | | |

Dimensions

■ M6 Terminal

Unit: mm | Dimensions: 552 Length X 110 Width X 288 Height (288 Height incl. Terminal)

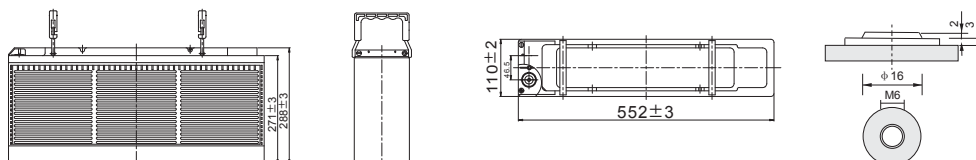



Constant Current Discharge (Amperes) at 25°C

| F.V/Time | 10min | 15min | 20min | 30min | 45min | 1h | 2h | 3h | 4h | 5h | 6h | 8h | 10h | 20h |
|------------|-------|-------|-------|-------|-------|------|------|------|------|------|------|------|------|------|
| 1.85V/cell | 216.9 | 190.8 | 171.0 | 136.8 | 105.8 | 85.7 | 50.9 | 37.3 | 29.9 | 25.1 | 21.7 | 17.2 | 14.3 | 7.60 |
| 1.80V/cell | 252.0 | 220.2 | 190.8 | 148.5 | 112.6 | 90.6 | 52.7 | 38.6 | 30.8 | 25.8 | 22.3 | 17.8 | 15.0 | 7.94 |
| 1.75V/cell | 278.1 | 237.0 | 203.4 | 154.8 | 115.8 | 93.0 | 53.9 | 39.2 | 31.2 | 26.1 | 22.6 | 18.1 | 15.2 | 8.02 |
| 1.70V/cell | 296.1 | 248.4 | 211.5 | 160.5 | 118.8 | 94.5 | 54.7 | 39.7 | 31.6 | 26.4 | 22.9 | 18.3 | 15.3 | 8.07 |
| 1.65V/cell | 309.6 | 256.8 | 216.0 | 163.8 | 121.0 | 95.9 | 55.4 | 40.1 | 31.9 | 26.7 | 23.1 | 18.5 | 15.5 | 8.12 |
| 1.60V/cell | 323.1 | 264.0 | 222.3 | 167.4 | 123.4 | 97.5 | 56.1 | 40.6 | 32.2 | 27.1 | 23.5 | 18.7 | 15.6 | 8.16 |

Constant Power Discharge (Watts/cell) at 25°C

| F.V/Time | 10min | 15min | 20min | 30min | 45min | 1h | 2h | 3h | 4h | 5h | 6h | 8h | 10 | 20h |
|------------|-------|-------|-------|-------|-------|-------|-------|------|------|------|------|------|------|------|
| 1.85V/cell | 405.0 | 359.8 | 325.8 | 263.5 | 205.5 | 166.9 | 99.9 | 73.4 | 59.0 | 49.6 | 43.0 | 34.4 | 28.7 | 15.2 |
| 1.80V/cell | 465.1 | 409.8 | 358.2 | 281.7 | 217.0 | 175.6 | 102.8 | 75.6 | 60.5 | 50.8 | 44.0 | 35.5 | 29.9 | 15.9 |
| 1.75V/cell | 505.1 | 435.7 | 378.2 | 291.2 | 221.1 | 179.5 | 104.7 | 76.5 | 61.1 | 51.3 | 44.5 | 35.9 | 30.2 | 16.0 |
| 1.70V/cell | 525.7 | 450.3 | 390.4 | 300.3 | 226.0 | 181.8 | 105.9 | 77.4 | 61.8 | 51.6 | 45.0 | 36.3 | 30.5 | 16.1 |
| 1.65V/cell | 547.6 | 463.7 | 397.1 | 305.8 | 229.4 | 183.9 | 107.2 | 77.9 | 62.3 | 52.3 | 45.3 | 36.6 | 30.8 | 16.2 |
| 1.60V/cell | 555.7 | 467.2 | 402.9 | 308.5 | 231.4 | 185.3 | 107.6 | 78.3 | 62.5 | 52.8 | 45.9 | 36.9 | 31.0 | 16.2 |

Discharge Characteristics

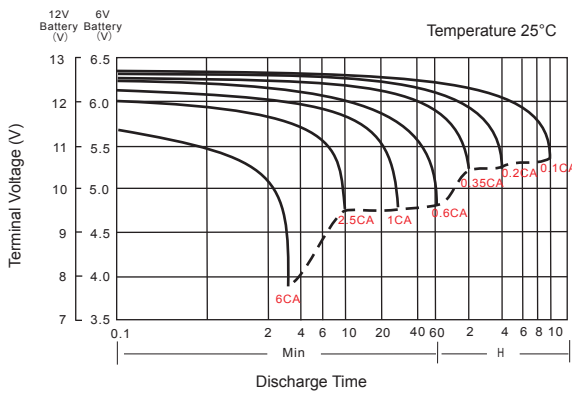

Float Charging Characteristics

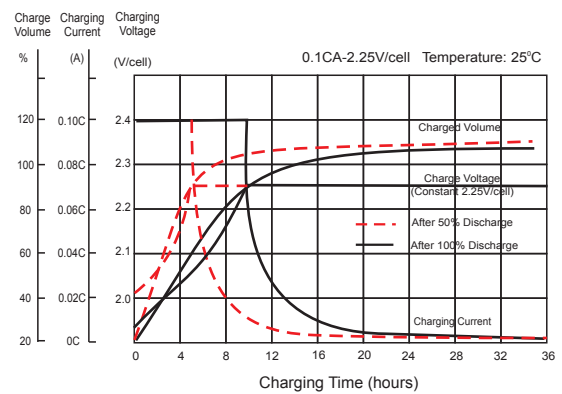

Temperature Effects in Relation to Battery Capacity

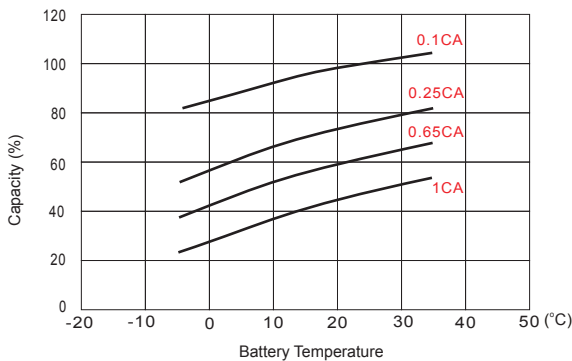

Effect of Temperature on Long Term Float Life

